

This division of land is in compliance with the applicable Burton Township zoning resolution.

Date: _____

Signature _____

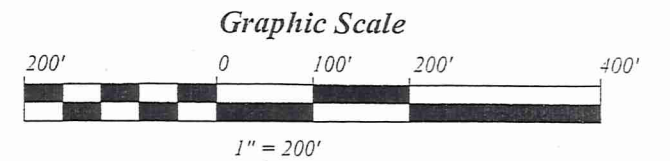
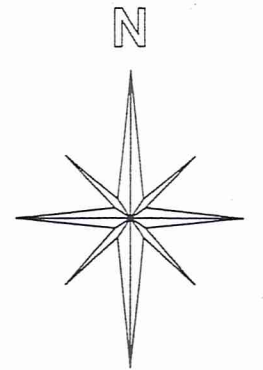
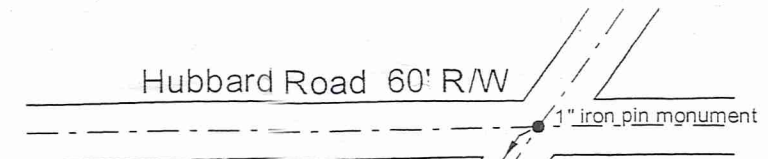

Abner J. and Mary Ann Hershberger
1771 - 1824
04-150982

Kenneth C. and Ruth M. Burnett
733 - 17
04-013460

Ervin R. and Miriam Miller
825 - 1080
04-008900

Andrew J. and Martha O. Mullet
1855 - 677
04-150534

Harvey R. and Lydia R. Miller
1847 - 2017
04-066800

Matthew M. and Kathryn Kurtz
1879 - 1264
04-062960

0.4632 Acres
 N 0°58'44" W 25.00'
 N 89°07'06" E 807.00'
 S 89°07'06" W 807.00'
 N 0°58'44" W 25.00'

John H. Jr. and Edna D. Mullet
Nelson L. and Nancy J. Yoder
1855 - 669
32-072296

Harvey R. and Lydia R. Miller
1847 - 2017
32-029900

Jug Street 60' R/W
3352.80'
S 34°38'03" W

**SURVEY PLAT & LEGAL DESCRIPTION
APPROVED PER R.C. 315.251**

PAK 2/28/14
**GEAUGA COUNTY AUDITOR
TAX MAP DEPT.**

- 5/8" x 30" rebar set capped "J W Daniel"
- Iron pin found
- 1" iron pin found in monument box

Bearings are to an assumed meridian and are used to denote angles only.

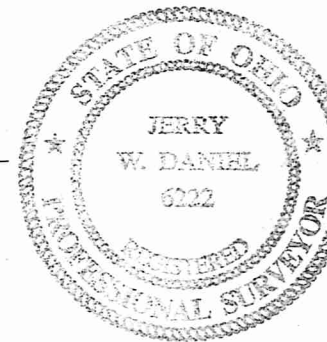

I hereby certify that I have surveyed the land shown hereon in accordance with the provisions of chapter 4733-37 of the Ohio Administrative Code and that the same is true and correct to the best of my ability.

Jerry W. Daniel 1-3-13
Jerry W. Daniel P.S. No. 6222

Map of Survey for Harvey R. and Lydia R. Miller

Lot 97
Burton Township
Geauga County, Ohio

J W Daniel & Associates, Inc.
101 North Center Street
Newton Falls, Ohio 44444
May, 2011 Job No. 1129B
Rev. 1-03-13

BUROO226

Description of Land
for
Harvey R. and Lydia R. Miller

(0.4632 Acres)

Situated in the Township of Burton, County of Geauga, and State of Ohio, and known as being part of Lot 97 in said township, and further bounded and described as follows:

Beginning at a 1" iron pin found in a monument box on the centerline of Jug Street (60' R/W) at the northeast corner of land conveyed to Harvey R. and Lydia R. Miller by deed recorded in Volume 1847, Page 2017 of Geauga County Record of Deeds (Parcel # 32-029900), said point being South 34°38'03" West, a distance of 3352.80 feet from a 1" iron pin found at the centerline intersection of Hubbard Road (60' R/W) and said Jug Street;

thence South 89°07'06" West, along the north line of said Miller's land, also being the line between Burton Township and Troy Township, a distance of 348.00 feet to an iron pin set at the southwest corner of Lot 98 and the TRUE PLACE OF BEGINNING for the parcel herein described:

thence South 89°07'06" West, along the north line of said Miller's land, and along the north line of land conveyed to John H. Jr. and Edna D. Mullet and Nelson L. and Nancy J. Yoder by deed recorded in Volume 1855, Page 669 of Geauga County Record of Deeds (Parcel # 32-072296), and along the line between Burton Township and Troy Township, a distance of 807.00 feet to a 5/8" iron pin found at the southeast corner of land conveyed to Abner J. and Mary Ann Hershberger by deed recorded in Volume 1771, Page 1824 of Geauga County Record of Deeds (Parcel # 04-150982);

thence North 0°58'44" West, along the east line of said Hershberger's land, a distance of 25.00 feet to an iron pin set at the west line of another parcel of land conveyed to Harvey R. and Lydia R. Miller by deed recorded in Volume 1847, Page 2017 of Geauga County Record of Deeds (Parcel # 04-066800);

thence North 89°07'06" East, along the south line of said Miller's land, a distance of 807.00 feet to an iron pin set at the southwest corner of land conveyed to Matthew M. and Kathryn Kurtz by deed recorded in Volume 1879, Page 1264 of Geauga County Record of Deeds (Parcel # 04-062960);

thence South 0°58'44" East, along the west line of said Kurtz' land, and also along the line between Lot 97 and Lot 98, a distance of 25.00 feet to a point and the true place of beginning and containing therein 0.4632 acres of land as surveyed in May, 2011 by Jerry W. Daniel, P.S. #6222.

Deed of record: 196 - 392 to Kazimir Nowakowski.

Bearings are to an assumed meridian and are used to denote angles only.

Iron pins set are 5/8" x 30" rebar capped "J W Daniel".

Jerry W. Daniel
01-03-13

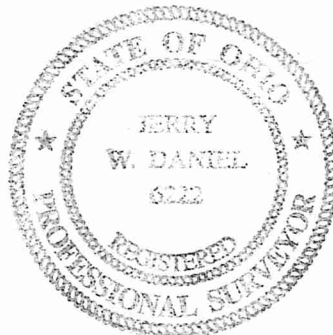

SURVEY PLAT & LEGAL DESCRIPTION
APPROVED PER R.C. 315.251

PAK 2 28, 14

GEAUGA COUNTY AUDITOR
TAX MAP DEPT.